

The use of this data/drawing by the recipient acts as an agreement of the following statements:  
 If you do not agree with any of the following information supplied to you please do not use the data/drawing and report any discrepancies in writing to Focus Architecture & Surveying before proceeding.  
 All drawings are based upon site information supplied by third parties/sub contractors and as such their accuracy cannot be guaranteed. All features are approximate and subject to clarification by a detailed topographical survey. Structures service enquiries and confirmation of the legal boundaries. Check all dimensions on site. Drawings printed on mediums such as paper are not to be relied upon for scaling purposes as dimensional inaccuracies occur resulting from changes in environmental conditions. Use figured dimensions in all cases. All dimensions to be in metric standards unless stated otherwise.  
 Property of Focus Architecture & Surveying. All rights of the copyright holder reserved.  
 Unauthorised copying, hiring, lending of this data for financial or commercial gain prohibited.

Revision :	Drawn :	Date :
01 First Issue	LS	22.10.2025
02 Relocation of Goods Door	LS	27.10.2025

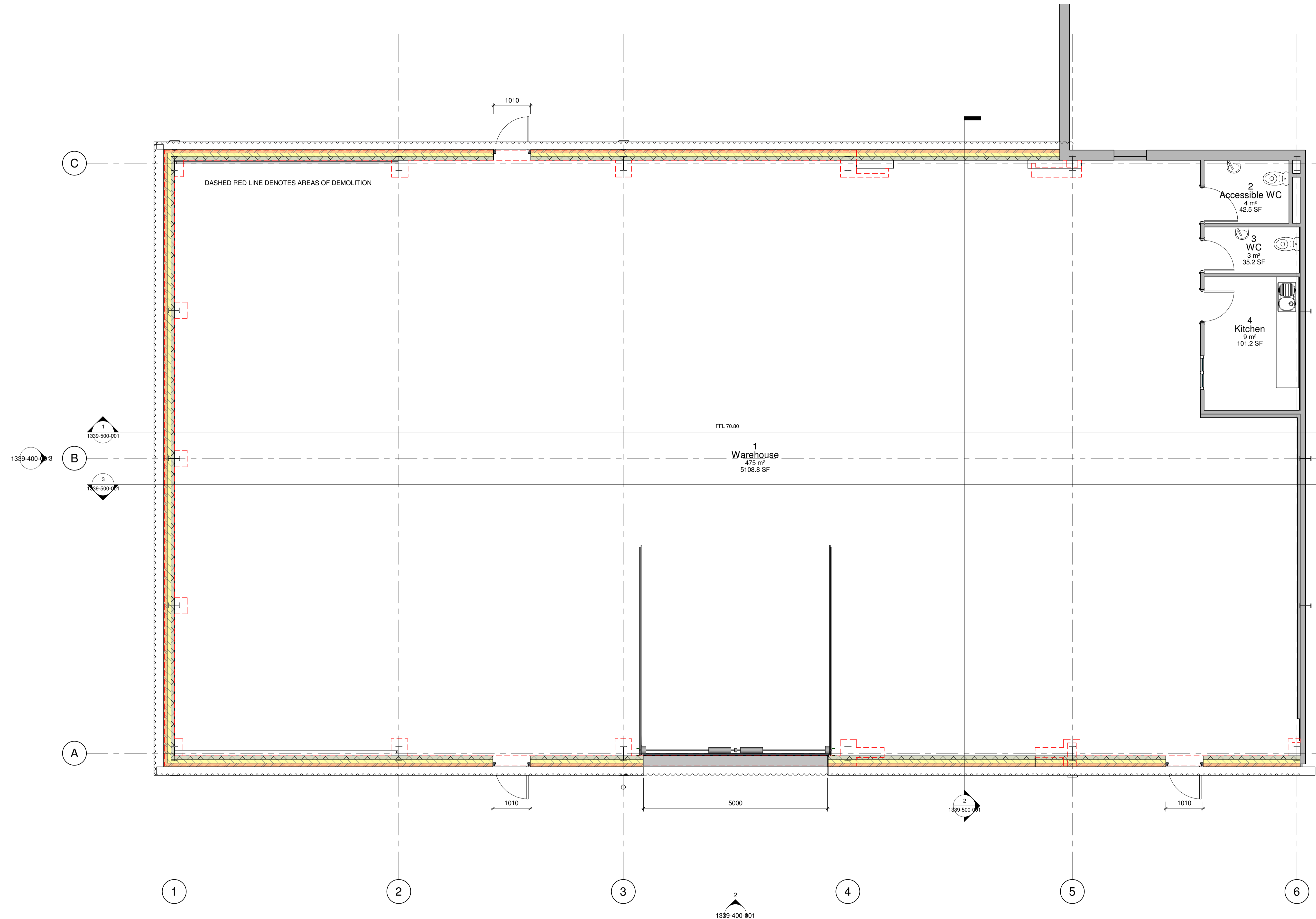

**0.0 - PRELIMINARY- Ground Floor - Masonry Setting Out**  
 1 : 50

**FOCUS**  
 Architecture • Surveying  
 UNIT 6, RAKE HOUSE FARM, RAKE LANE, NORTH  
 SHIELDS, TYNE & WEAR, NE29 8EQ

Client :  
**Cleckheaton Construction**

Address :  
 Unit 8A, Grange Road, Industrial Estate,  
 Batley

Drawing :  
**PRELIMINARY - General Arrangements**

Job Ref :	Dwg No :	Revision :
AS-1339	1339-300-001	02

Drawn :	Checked :	Scale :
LS	LS	@A1 1 : 50

Status :  
**PRELIMINARY INFORMATION**